

## NOTES

1. DO NOT SCALE THIS DRAWING.
2. THIS DRAWING TO BE READ IN CONJUNCTION WITH ALL OTHER RELEVANT ENGINEER'S AND ARCHITECT'S DRAWINGS AND SPECIFICATIONS.

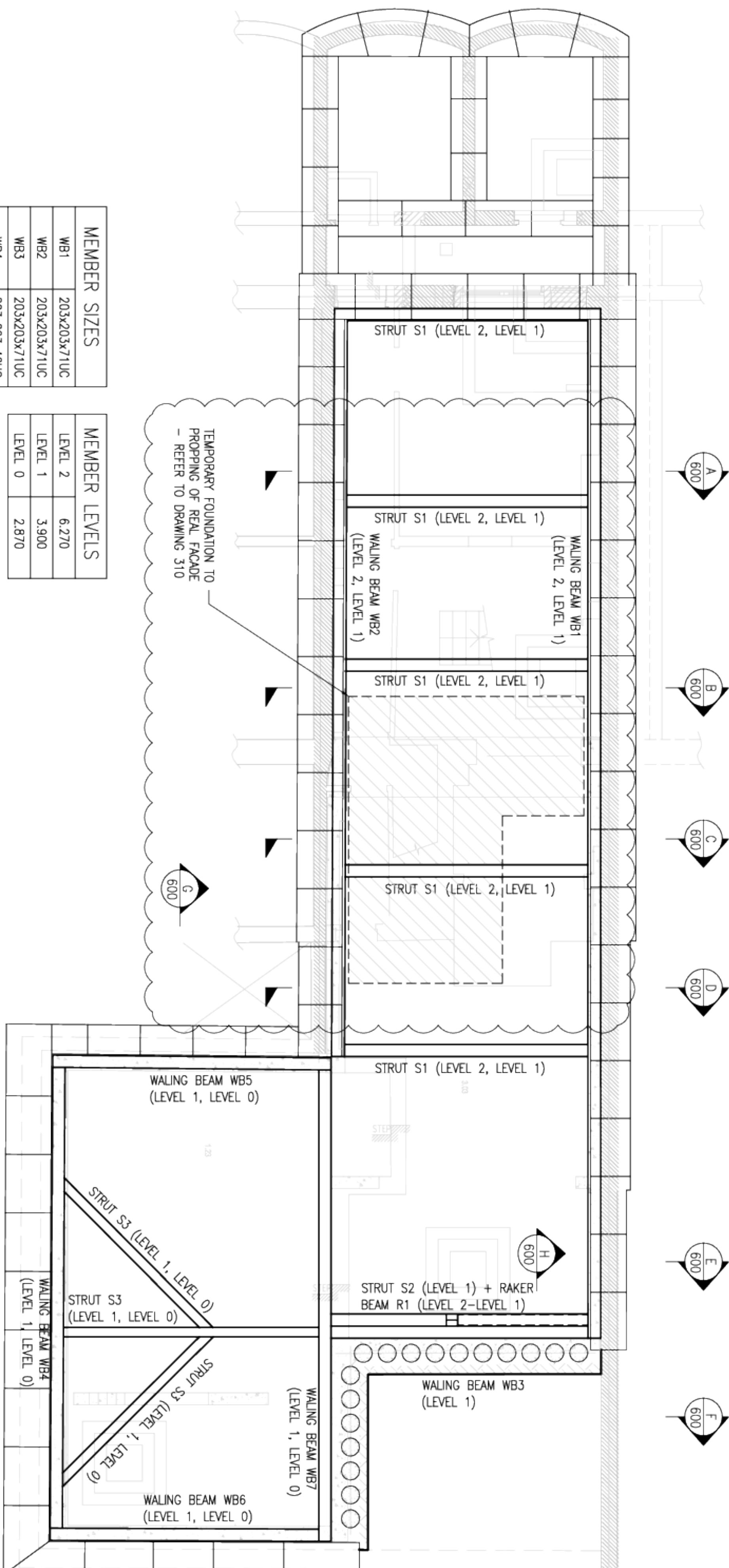

MEMBER SIZES		MEMBER LEVELS	
WB1	203x203x71UC	LEVEL 2	6.270
WB2	203x203x71UC	LEVEL 1	3.900
WB3	203x203x71UC	LEVEL 0	2.870

MEMBER SIZES	
WB1	203x203x71UC
WB2	203x203x71UC
WB3	203x203x71UC
WB4	203x203x46UC
WB5	203x203x46UC
WB6	203x203x46UC
WB7	203x203x46UC
S1	203x203x46UC
S2	203x203x46UC
S3	152x152x37UC
R1	203x203x46UC

WALING AND STRUT PLAN FOR  
BASEMENT EXCAVATION  
SCALE 1:50

P2	19/06/14	DS	JL	TEMPORARY PROPPING ADDED. WALING BEAMS ADJUDGED
P1	28/04/14	DS	JL	PRELIMINARY ISSUE
Mark	Date	By	Chkd	Revision notes

IN ADDITION TO THE HAZARD/RISKS NORMALLY ASSOCIATED WITH THE TYPES OF WORK DETAILED ON THIS DRAWING, NOTE THE FOLLOWING RISKS AND INFORMATION.

CONSTRUCTION

NO SIGNIFICANT RESIDUAL HAZARDS BEYOND THOSE KNOWN TO A COMPETENT CONTRACTOR.

DEMOLITION  
NO SIGNIFICANT RESIDUAL HAZARDS BEYOND THOSE KNOWN TO A  
COMPETENT CONTRACTOR.

IT IS ASSUMED THAT ALL WORKS WILL BE CARRIED OUT BY A COMPETENT CONTRACTOR WORKING, WHERE APPROPRIATE, TO AN APPROVED METHOD STATEMENT.

37 CHESTER ROW  
LONDON, SW1

Drawing Title  
**WALING AND STRUT PLAN  
FOR BASEMENT EXCAVATION**

Client  
**MRS FERYAL KARMALLY**

Drawn:	OS	Checked:	AL	Approved:	NMS
Date:	28/04/14	Date:	28/04/14	Date:	28/04/14

Scale at A1: 1:50

STUDY: **PRELIMINARY**

25 Buckingham Palace Road, London, SW1W 0PP  
 Tel: 020 7626 2035, Fax: 020 7626 8207, [www.fairhurst.co.uk](http://www.fairhurst.co.uk)

**FAIRHURST**  
 consulting engineers **gga**